

OPTIMUM DIMENSIONS TABLE	
OFFSET DISTANCE (C)	OPENING WIDTH (E)
5.5' MAX	16' MIN
5.0'	17' ±
4.5'	18' ±
4.0'	19' ±
3.5' OR LESS	20' ±

DIMENSIONS TABLE				
A STREET WIDTH	B CURB RETURN RADIUS	C OFFSET DISTANCE	D CIRCLE DIAMETER	E OPENING WIDTH
20'	<15'	RECONSTRUCT CURBS		
	15'	5.5'	9'	16'+
	18'	5.0'	10'	17'+
	20'	4.5'	11'	18'-
	25'	4.0'	12'	19'+
24'	<12'	RECONSTRUCT CURBS		
	12'	5.5'	13'	16'
	15'	5.0'	14'	17'-
	20'	4.5'	15'	18'+
	25'	3.5'	17'	20'-
25'	<12'	RECONSTRUCT CURBS		
	12'	5.5'	14'	16'+
	15'	5.0'	15'	17'-
	18'	4.5'	16'	18'-
	20'	4.5'	16'	18'+
30'	10'	5.5'	19'	16'+
	12'	5.0'	20'	17'-
	15'	5.0'	20'	17'+
	18'	4.5'	21'	18'+
	20'	4.0'	22'	19'+
32'	10'	5.5'	21'	16'+
	12'	5.0'	22'	17'-
	15'	4.5'	23'	18'-
	18'	4.0'	24'	19'-
	20'	4.0'	24'	19'+
36'	10'	5.0'	26'	17'-
	12'	5.0'	26'	17'+
	15'	4.5'	27'	18'+
	18'	4.0'	28'	19'+
	20'	3.5'	29'	20'-
40'	10'	5.0'	30'	17'+
	12'	4.5'	31'	18'+
	15'	4.0'	32'	19'-
	18'	3.5'	33'	20'-
	20'	3.0'	34'	20'+
25'	1.0'	38'	20'	

INTERSECTION GEOMETRY

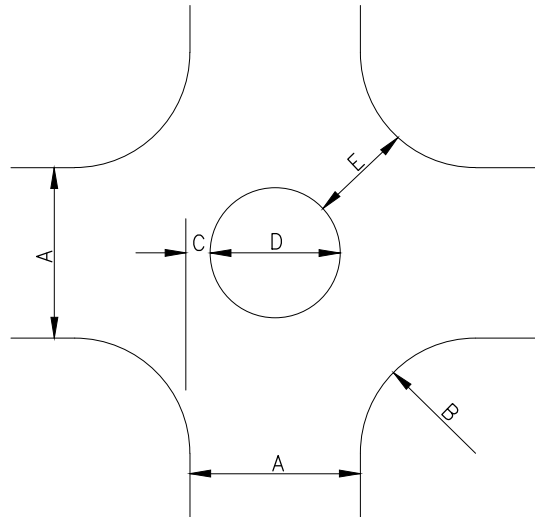

NOTES:

1. USE DIMENSION SCHEDULE AS A DESIGN GUIDE. FINAL DIMENSIONS TO BE DETERMINED BY THE ENGINEER.
2. FOR PLANTER ISLAND SPECIFICATIONS SEE STANDARD DRAWING DM.A8.3.

NOT TO SCALE



CITY OF DES MOINES
PUBLIC WORKS DEPARTMENT

ENGINEERING SERVICES
21650 11TH AVENUE SOUTH
DES MOINES, IA 50319



TRAFFIC CIRCLE DIMENSIONS

DM.A8.2

REVISED: 02/23